

SH300-H Exclusive Use for Hardened Steels

- Suitable for Semi-Finishing and Finishing of 45~70HRC Hardened Steels.
- Newly high strength, high toughness matrix materials base material with five elements coating, lengthens the tool life significantly.
- Special tool design, high precision control, enables spectacular hardened steels machining.



SH300-SS4-H

4 Flute, Stub Length

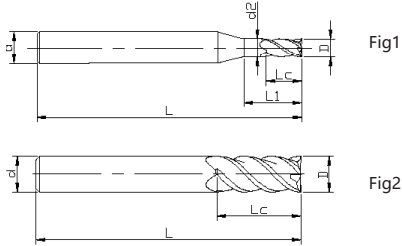

Ordering Code	D Mill dia	Lc Flute length	L Overall length	d Shank dia.	Figure No.	Stock
SH300-SS4-31002-H	1	2	50	3	1	○
SH300-SS4-01002-H	1	2	50	4	1	○
SH300-SS4-61002-H	1	2	50	6	1	○
SH300-SS4-31503-H	1.5	3	50	3	1	○
SH300-SS4-01503-H	1.5	3	50	4	1	○
SH300-SS4-61503-H	1.5	3	50	6	1	○
SH300-SS4-33004-H	2	4	50	3	1	○
SH300-SS4-03004-H	2	4	50	4	1	○
SH300-SS4-63004-H	2	4	50	6	1	○
SH300-SS4-33006-H	3	6	50	3	2	○
SH300-SS4-03006-H	3	6	50	4	1	○

- Stock
- Available upon order

D	Tolerance
D ≤ 8	0 -0.01
D > 8	0 -0.015

unit (mm)

Workpiece Material				
P		H		
1 2 3 4	5	1 2	3	4
Carbon Steels Alloy Steels	Alloy Steels	Hardened Steel	Hardened Steel	Hardened Steel
(< 35HRC)	(35-48 HRC)	(< 55HRC)	(55-60HRC)	(> 60HRC)
	○	○	○	○

○ Most Suitable ○ Suitable

SH300-SS4-H

4 Flute, Stub Length

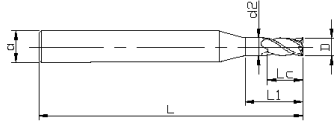

Fig1

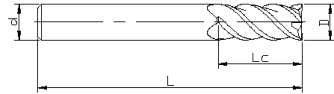

Fig2



Ordering Code	D Mill dia	Lc Flute length	L Overall length	d Shank dia.	Figure No.	Stock
SH300-SS4-63006-H	3	6	50	6	1	○
SH300-SS4-04008-H	4	8	50	4	2	○
SH300-SS4-64008-H	4	8	50	6	1	○
SH300-SS4-05010-H	5	10	50	6	1	○
SH300-SS4-06012-H	6	12	50	6	2	○
SH300-SS4-08012E-H	8	12	75	8	2	○
SH300-SS4-08016-H	8	16	60	8	2	○
SH300-SS4-10020-H	10	20	75	10	2	○
SH300-SS4-12024-H	12	24	75	12	2	○
SH300-SS4-14028-H	14	28	100	14	2	○
SH300-SS4-16032-H	16	32	100	16	2	○

- Stock
- Available upon order

D	Tolerance
D ≤ 8	0 -0.01
D > 8	0 -0.015

unit (mm)

Workpiece Material				
P		H		
1 2 3 4	5	1 2	3	4
Carbon Steels Alloy Steels	Alloy Steels	Hardened Steel	Hardened Steel	Hardened Steel
(< 35HRC)	(35-48 HRC)	(< 55HRC)	(55-60HRC)	(> 60HRC)
	○	○	○	○

- Most Suitable
- Suitable

SH300-S4-H

4 Flute, Standard Length

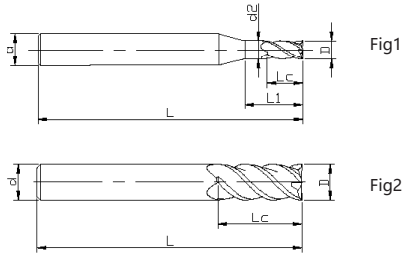

Ordering Code	D Mill dia	Lc Flute length	L Overall length	d Shank dia.	Figure No.	Stock
SH300-S4-31004-H	1	3.5	50	3	1	○
SH300-S4-01004-H	1	3.5	50	4	1	○
SH300-S4-61004-H	1	3.5	50	6	1	○
SH300-S4-31505-H	1.5	5	50	3	1	○
SH300-S4-01505-H	1.5	5	50	4	1	○
SH300-S4-61505-H	1.5	5	50	6	1	○
SH300-S4-32007-H	2	7	50	3	1	○
SH300-S4-02007-H	2	7	50	4	1	○
SH300-S4-62007-H	2	7	50	6	1	○
SH300-S4-33010-H	3	10	50	3	2	○

- Stock
- Available upon order

D	Tolerance
D ≤ 8	0 -0.01
D > 8	0 -0.015

unit (mm)

Workpiece Material				
P		H		
1 2 3 4	5	1 2	3	4
Carbon Steels Alloy Steels	Alloy Steels	Hardened Steel	Hardened Steel	Hardened Steel
(< 35HRC)	(35-48 HRC)	(< 55HRC)	(55-60HRC)	(> 60HRC)
	○	○	○	○

○ Most Suitable ○ Suitable

SH300-S4-H

4 Flute, Standard Length

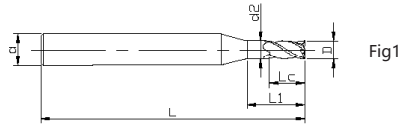

Fig1

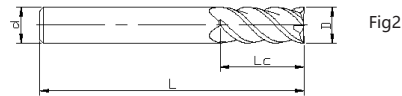

Fig2



Ordering Code	D Mill dia	Lc Flute length	L Overall length	d Shank dia.	Figure No.	Stock
SH300-S4-03010-H	3	10	50	4	1	○
SH300-S4-63010-H	3	10	50	6	1	○
SH300-S4-04012-H	4	12	50	4	2	●
SH300-S4-64012-H	4	12	50	6	1	○
SH300-S4-05015-H	5	15	50	6	1	○
SH300-S4-06015-H	6	15	50	6	2	●
SH300-S4-08020-H	8	20	60	8	2	●
SH300-S4-08020E-H	8	20	75	8	2	○
SH300-S4-10025-H	10	25	75	10	2	●
SH300-S4-10025E-H	10	25	90	10	2	○

- Stock
- Available upon order

D	Tolerance
D ≤ 8	0 -0.01
D > 8	0 -0.015

unit (mm)

Workpiece Material				
P		H		
1 2 3 4	5	1 2	3	4
Carbon Steels Alloy Steels	Alloy Steels	Hardened Steel	Hardened Steel	Hardened Steel
(< 35HRC)	(35-48 HRC)	(< 55HRC)	(55-60HRC)	(> 60HRC)
	○	○	⊙	⊙

⊙ Most Suitable ○ Suitable

SH300-S4-H

4 Flute, Standard Length

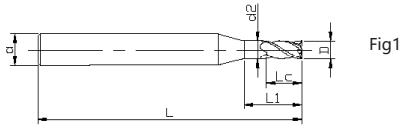

Fig1

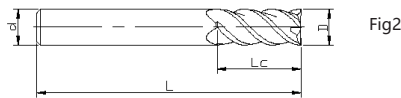
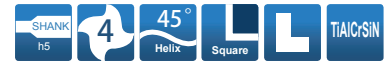

Fig2



Ordering Code	D Mill dia	Lc Flute length	L Overall length	d Shank dia.	Figure No.	Stock
SH300-S4-12030-H	12	30	75	12	2	●
SH300-S4-12030E-H	12	30	90	12	2	○
SH300-S4-14035-H	14	35	100	14	2	○
SH300-S4-16040-H	16	40	100	16	2	○
SH300-S4-18040-H	18	40	100	18	2	○
SH300-S4-20045-H	20	45	100	20	2	○

- Stock
- Available upon order

D	Tolerance
D ≤ 8	0 -0.01
D > 8	0 -0.015

unit (mm)

Workpiece Material				
P		H		
1 2 3 4	5	1 2	3	4
Carbon Steels Alloy Steels	Alloy Steels	Hardened Steel	Hardened Steel	Hardened Steel
(< 35HRC)	(35-48 HRC)	(< 55HRC)	(55-60HRC)	(> 60HRC)
	○	○	○	○

- Most Suitable
- Suitable

SH300-SH4-H

4 Flute, With Long Shank Length

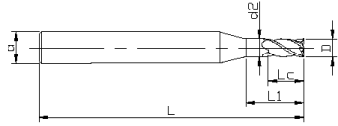

Fig1

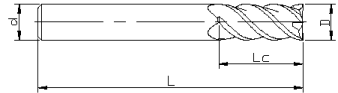

Fig2



Ordering Code	D Mill dia	Lc Flute length	L Overall length	d Shank dia.	Figure No.	Stock
SH300-SH4-31004-H	1	3.5	60	3	1	○
SH300-SH4-01004-H	1	3.5	60	4	1	○
SH300-SH4-61004-H	1	3.5	60	6	1	○
SH300-SH4-31505-H	1.5	5	60	3	1	○
SH300-SH4-01505-H	1.5	5	60	4	1	○
SH300-SH4-61505-H	1.5	5	60	6	1	○
SH300-SH4-32007-H	2	7	60	3	1	○
SH300-SH4-02007-H	2	7	60	4	1	○
SH300-SH4-62007-H	2	7	60	6	1	○
SH300-SH4-33010-H	3	10	60	3	2	○
SH300-SH4-03010-H	3	10	60	4	1	○
SH300-SH4-63010-H	3	10	60	6	1	○

- Stock
- Available upon order

D	Tolerance
D ≤ 8	0 -0.01
D > 8	0 -0.015

unit (mm)

Workpiece Material				
P		H		
1 2 3 4	5	1 2	3	4
Carbon Steels Alloy Steels	Alloy Steels	Hardened Steel	Hardened Steel	Hardened Steel
(< 35HRC)	(35-48 HRC)	(< 55HRC)	(55-60HRC)	(> 60HRC)
	○	○	○	○

- Most Suitable
- Suitable

SH300-SH4-H

4 Flute, With Long Shank Length

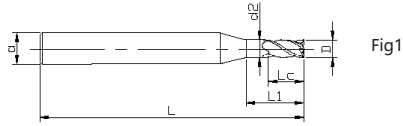

Fig1

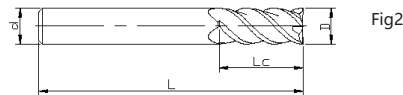

Fig2



Ordering Code	D Mill dia	Lc Flute length	L Overall length	d Shank dia.	Figure No.	Stock
SH300-SH4-04012-H	4	12	60	4	2	○
SH300-SH4-64012-H	4	12	60	6	1	○
SH300-SH4-05015-H	5	15	60	6	1	○
SH300-SH4-06015-H	6	15	60	6	2	○
SH300-SH4-08020E-H	8	20	100	8	2	○
SH300-SH4-10025-H	10	25	100	10	2	○
SH300-SH4-12030-H	12	30	100	12	2	○
SH300-SH4-14035-H	14	35	120	14	2	○
SH300-SH4-16040-H	16	40	120	16	2	○
SH300-SH4-18040-H	18	40	150	18	2	○
SH300-SH4-20045-H	20	45	150	20	2	○

- Stock
- Available upon order

D	Tolerance
D ≤ 8	0 -0.01
D > 8	0 -0.015

unit (mm)

Workpiece Material				
P		H		
1 2 3 4	5	1 2	3	4
Carbon Steels Alloy Steels	Alloy Steels	Hardened Steel	Hardened Steel	Hardened Steel
(< 35HRC)	(35-48 HRC)	(< 55HRC)	(55-60HRC)	(> 60HRC)
	○	○	○	○

- Most Suitable
- Suitable

SH300-SL4-H

4 Flute, Long Flute Length

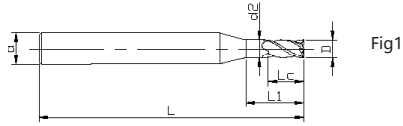

Fig1

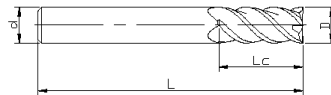
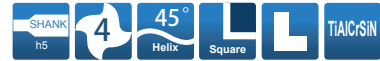

Fig2



Ordering Code	D Mill dia	Lc Flute length	L Overall length	d Shank dia.	Figure No.	Stock
SH300-SL4-01004-H	1	4	60	4	1	○
SH300-SL4-01006-H	1	6	60	4	1	●
SH300-SL4-61004-H	1	4	60	6	1	○
SH300-SL4-01508-H	1.5	8	60	4	1	●
SH300-SL4-61508-H	1.5	8	60	6	1	○
SH300-SL4-02008-H	2	8	60	4	1	○
SH300-SL4-62008-H	2	8	60	6	1	○
SH300-SL4-03012-H	3	12	60	4	1	○
SH300-SL4-63012-H	3	12	60	6	1	○
SH300-SL4-04016-H	4	16	60	4	2	○
SH300-SL4-64016-H	4	16	60	6	1	○

- Stock
- Available upon order

D	Tolerance
D ≤ 8	0 -0.01
D > 8	0 -0.015

unit (mm)

Workpiece Material				
P		H		
1 2 3 4	5	1 2	3	4
Carbon Steels Alloy Steels	Alloy Steels	Hardened Steel	Hardened Steel	Hardened Steel
(< 35HRC)	(35-48 HRC)	(< 55HRC)	(55-60HRC)	(> 60HRC)
	○	○	○	○

- Most Suitable
- Suitable

SH300-SL4-H

4 Flute, Long Flute Length

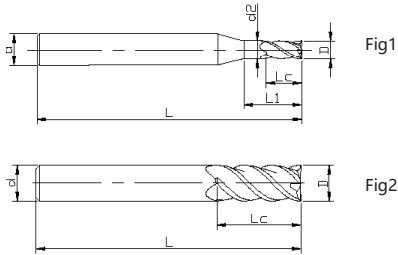

Ordering Code	D Mill dia	Lc Flute length	L Overall length	d Shank dia.	Figure No.	Stock
SH300-SL4-05020-H	5	20	60	6	1	○
SH300-SL4-06020-H	6	20	60	6	2	○
SH300-SL4-06025E-H	6	25	75	6	2	○
SH300-SL4-08025-H	8	25	75	8	2	○
SH300-SL4-08030-H	8	30	75	8	2	○
SH300-SL4-10040-H	10	40	100	10	2	○
SH300-SL4-12040-H	12	40	100	12	2	○
SH300-SL4-14545-H	14	45	120	14	2	○
SH300-SL4-16055-H	16	55	120	16	2	○
SH300-SL4-20060-H	20	60	120	20	2	○

- Stock
- Available upon order

D	Tolerance
D ≤ 8	0 -0.01
D > 8	0 -0.015

unit (mm)

Workpiece Material				
P		H		
1 2 3 4	5	1 2	3	4
Carbon Steels Alloy Steels	Alloy Steels	Hardened Steel	Hardened Steel	Hardened Steel
(< 35HRC)	(35-48 HRC)	(< 55HRC)	(55-60HRC)	(> 60HRC)
	○	○	○	○

○ Most Suitable ○ Suitable

SH300-SN4-H

4 Flute, With Reduced Neck Diameter

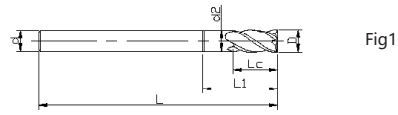

Fig1

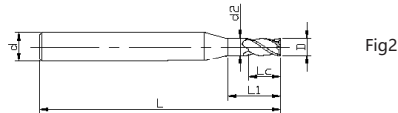
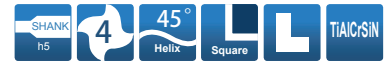

Fig2



Ordering Code	D Mill dia	Lc Flute length	d2 Neck dia	L1 Under neck length	L Overall length	d Shank dia.	Figure No.	Stock
SH300-SN4-31004-H	1	2	0.96	4	50	3	1	○
SH300-SN4-01004-H	1	2	0.96	4	50	4	1	○
SH300-SN4-61004-H	1	2	0.96	4	50	6	1	○
SH300-SN4-31004E-H	1	2	0.96	4	60	3	1	○
SH300-SN4-01004E-H	1	2	0.96	4	60	4	1	●
SH300-SN4-61004E-H	1	2	0.96	4	60	6	1	●
SH300-SN4-31506-H	1.5	3	1.45	6	50	3	1	○
SH300-SN4-01506-H	1.5	3	1.45	6	50	4	1	○
SH300-SN4-61506-H	1.5	3	1.45	6	50	6	1	○
SH300-SN4-31506E-H	1.5	3	1.45	6	60	3	1	○
SH300-SN4-01506E-H	1.5	3	1.45	6	60	4	1	○
SH300-SN4-61508E-H	1.5	3	1.45	8	60	4	1	○

- Stock
- Available upon order

D	Tolerance
D ≤ 8	0 -0.01
D > 8	0 -0.015

unit (mm)

Workpiece Material				
P		H		
1 2 3 4	5	1 2	3	4
Carbon Steels Alloy Steels	Alloy Steels	Hardened Steel	Hardened Steel	Hardened Steel
(< 35HRC)	(35-48 HRC)	(< 55HRC)	(55-60HRC)	(> 60HRC)
	○	○	○	○

- Most Suitable
- Suitable

SH300-SN4-H

4 Flute, With Reduced Neck Diameter

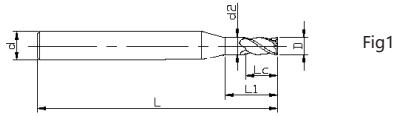

Fig1

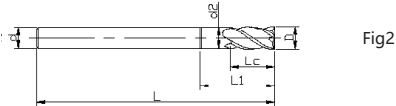

Fig2



Ordering Code	D Mill dia	Lc Flute length	d2 Neck dia	L1 Under neck length	L Overall length	d Shank dia.	Figure No.	Stock
SH300-SN4-61506E-H	1.5	3	1.45	6	60	6	1	●
SH300-SN4-32008-H	2	4	1.9	8	50	3	1	○
SH300-SN4-02008-H	2	4	1.9	8	50	4	1	○
SH300-SN4-62008-H	2	4	1.9	8	50	6	1	○
SH300-SN4-32008E-H	2	4	1.9	8	60	3	1	○
SH300-SN4-02008E-H	2	4	1.9	8	60	4	1	●
SH300-SN4-62008E-H	2	4	1.9	8	60	6	1	●
SH300-SN4-33012-H	3	6	2.9	12	50	3	2	○
SH300-SN4-03012-H	3	6	2.9	12	50	4	1	○
SH300-SN4-63012-H	3	6	2.9	12	50	6	1	○
SH300-SN4-33012E-H	3	6	2.9	12	60	3	2	○
SH300-SN4-03012E-H	3	6	2.9	12	60	4	1	○

- Stock
- Available upon order

D	Tolerance
D ≤ 8	0 -0.01
D > 8	0 -0.015

unit (mm)

Workpiece Material				
P		H		
1 2 3 4	5	1 2	3	4
Carbon Steels Alloy Steels	Alloy Steels	Hardened Steel	Hardened Steel	Hardened Steel
(< 35HRC)	(35-48 HRC)	(< 55HRC)	(55-60HRC)	(> 60HRC)
	○	○	○	○

○ Most Suitable ○ Suitable

SH300-SN4-H

4 Flute, With Reduced Neck Diameter

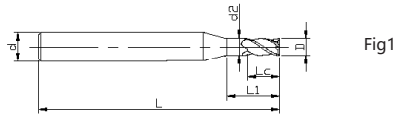

Fig1

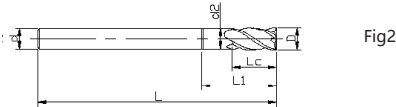

Fig2



Ordering Code	D Mill dia	Lc Flute length	d2 Neck dia	L1 Under neck length	L Overall length	d Shank dia.	Figure No.	Stock
SH300-SN4-63009E-H	3	6	2.9	9	60	6	1	●
SH300-SN4-63012E-H	3	6	2.9	12	60	6	1	●
SH300-SN4-64012E-H	4	8	3.9	12	60	6	1	●
SH300-SN4-04016-H	4	8	3.9	16	50	4	2	○
SH300-SN4-64016-H	4	8	3.9	16	50	6	1	○
SH300-SN4-04016E-H	4	8	3.9	16	60	4	2	○
SH300-SN4-64016E-H	4	8	3.9	16	60	6	1	○
SH300-SN4-05020-H	5	10	5.9	20	50	6	1	○
SH300-SN4-05020E-H	5	10	5.9	20	60	6	1	○
SH300-SN4-05020F-H	5	10	5.9	20	75	6	1	○
SH300-SN4-06018E-H	6	12	5.9	18	60	6	2	●
SH300-SN4-06024-H	6	12	5.9	24	75	6	2	○

- Stock
- Available upon order

D	Tolerance
D ≤ 8	0 -0.01
D > 8	0 -0.015

unit (mm)

Workpiece Material				
P		H		
1 2 3 4	5	1 2	3	4
Carbon Steels Alloy Steels	Alloy Steels	Hardened Steel	Hardened Steel	Hardened Steel
(< 35HRC)	(35-48 HRC)	(< 55HRC)	(55-60HRC)	(> 60HRC)
	○	○	○	○

- Most Suitable
- Suitable

SH300-SN4-H

4 Flute, With Reduced Neck Diameter

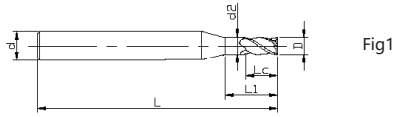

Fig1

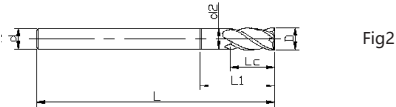

Fig2



Ordering Code	D Mill dia	Lc Flute length	d2 Neck dia	L1 Under neck length	L Overall length	d Shank dia.	Figure No.	Stock
SH300-SN4-06024E-H	6	12	5.9	24	90	6	2	○
SH300-SN4-06024F-H	6	12	5.9	24	100	6	2	○
SH300-SN4-08024-H	8	16	7.9	24	75	8	2	○
SH300-SN4-08032-H	8	16	7.9	32	75	8	2	●
SH300-SN4-08032E-H	8	16	7.9	32	100	8	2	○
SH300-SN4-10040-H	10	20	9.9	40	100	10	2	●
SH300-SN4-10040E-H	10	20	9.9	40	120	10	2	○
SH300-SN4-12048-H	12	24	11.9	48	100	12	2	●
SH300-SN4-12048E-H	12	24	11.9	48	120	12	2	○
SH300-SN4-14056-H	14	28	13.9	56	120	14	2	○
SH300-SN4-16064-H	16	32	15.9	64	120	16	2	○
SH300-SN4-20080-H	20	40	19.9	80	120	20	2	○

- Stock
- Available upon order

D	Tolerance
D ≤ 8	0 -0.01
D > 8	0 -0.015

unit (mm)

Workpiece Material				
P		H		
1 2 3 4	5	1 2	3	4
Carbon Steels Alloy Steels	Alloy Steels	Hardened Steel	Hardened Steel	Hardened Steel
(< 35HRC)	(35-48 HRC)	(< 55HRC)	(55-60HRC)	(> 60HRC)
	○	○	○	○

○ Most Suitable ○ Suitable

SH300-R4-H

4 Flute, Corner Radius

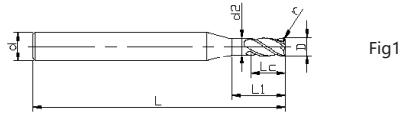

Fig1

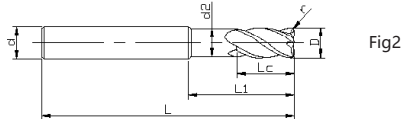

Fig2



Ordering Code	D Mill dia	Lc Flute length	r Corner Radius	L Overall length	d Shank dia.	Figure No.	Stock
SH300-R4-31001-H	1	3.5	0.1	50	3	1	○
SH300-R4-01001-H	1	3.5	0.1	50	4	1	○
SH300-R4-61001-H	1	3.5	0.1	50	6	1	○
SH300-R4-31002-H	1	3.5	0.2	50	3	1	○
SH300-R4-01002-H	1	3.5	0.2	50	4	1	○
SH300-R4-61002-H	1	3.5	0.2	50	6	1	○
SH300-R4-31501-H	1.5	5	0.1	50	3	1	○
SH300-R4-01501-H	1.5	5	0.1	50	4	1	○
SH300-R4-61501-H	1.5	5	0.1	50	6	1	○
SH300-R4-31502-H	1.5	5	0.2	50	3	1	○
SH300-R4-01502-H	1.5	5	0.2	50	4	1	○
SH300-R4-61502-H	1.5	5	0.2	50	6	1	○

- Stock
- Available upon order

D	Tolerance
D ≤ 8	0 -0.01
D > 8	0 -0.015

unit (mm)

Workpiece Material				
P		H		
1 2 3 4	5	1 2	3	4
Carbon Steels Alloy Steels	Alloy Steels	Hardened Steel	Hardened Steel	Hardened Steel
(< 35HRC)	(35-48 HRC)	(< 55HRC)	(55-60HRC)	(> 60HRC)
	○	○	⊙	⊙

⊙ Most Suitable ○ Suitable

SH300-R4-H

4 Flute, Corner Radius

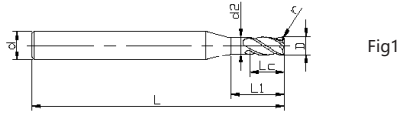

Fig1

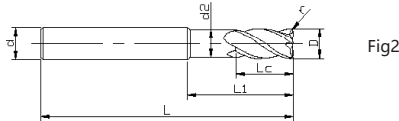
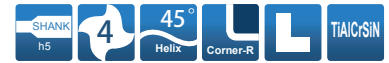

Fig2



Ordering Code	D Mill dia	Lc Flute length	r Corner Radius	L Overall length	d Shank dia.	Figure No.	Stock
SH300-R4-32001-H	2	7	0.1	50	3	1	○
SH300-R4-02001-H	2	7	0.1	50	4	1	○
SH300-R4-62001-H	2	7	0.1	50	6	1	○
SH300-R4-32002-H	2	7	0.2	50	3	1	○
SH300-R4-02002-H	2	7	0.2	50	4	1	●
SH300-R4-62002-H	2	7	0.2	50	6	1	○
SH300-R4-33002-H	3	10	0.2	50	3	2	○
SH300-R4-03002-H	3	10	0.2	50	4	1	○
SH300-R4-63002-H	3	10	0.2	50	6	1	○
SH300-R4-33005-H	3	10	0.5	50	3	2	○
SH300-R4-03005-H	3	10	0.5	50	4	1	●
SH300-R4-63005-H	3	10	0.5	50	6	1	○

- Stock
- Available upon order

D	Tolerance
D ≤ 8	0 -0.01
D > 8	0 -0.015

unit (mm)

Workpiece Material				
P		H		
1 2 3 4	5	1 2	3	4
Carbon Steels Alloy Steels	Alloy Steels	Hardened Steel	Hardened Steel	Hardened Steel
(< 35HRC)	(35-48 HRC)	(< 55HRC)	(55-60HRC)	(> 60HRC)
	○	○	○	○

○ Most Suitable ○ Suitable

SH300-R4-H

4 Flute, Corner Radius

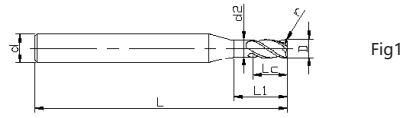

Fig1

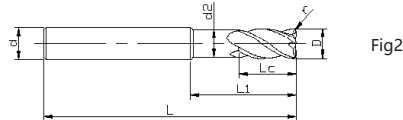

Fig2



Ordering Code	D Mill dia	Lc Flute length	r Corner Radius	L Overall length	d Shank dia.	Figure No.	Stock
SH300-R4-04002-H	4	12	0.2	50	4	2	○
SH300-R4-64002-H	4	12	0.2	50	6	1	○
SH300-R4-04005-H	4	12	0.5	50	4	2	○
SH300-R4-64005-H	4	12	0.5	50	6	1	○
SH300-R4-05002-H	5	15	0.2	50	6	1	○
SH300-R4-05005-H	5	15	0.5	50	6	1	○
SH300-R4-06005-H	6	15	0.5	50	6	2	●
SH300-R4-06010-H	6	15	1	50	6	2	○
SH300-R4-08005-H	8	20	0.5	60	8	2	●
SH300-R4-08005E-H	8	20	0.5	75	8	2	○
SH300-R4-08010-H	8	20	1	60	8	2	○
SH300-R4-08010E-H	8	20	1	75	8	2	○

- Stock
- Available upon order

D	Tolerance
D ≤ 8	0 -0.01
D > 8	0 -0.015

unit (mm)

Workpiece Material				
P		H		
1 2 3 4	5	1 2	3	4
Carbon Steels Alloy Steels	Alloy Steels	Hardened Steel	Hardened Steel	Hardened Steel
(< 35HRC)	(35-48 HRC)	(< 55HRC)	(55-60HRC)	(> 60HRC)
	○	○	○	○

- Most Suitable
- Suitable

SH300-R4-H

4 Flute, Corner Radius

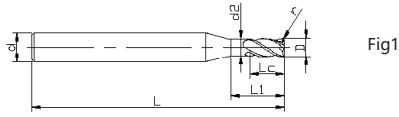

Fig1

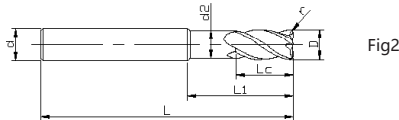

Fig2



Ordering Code	D Mill dia	Lc Flute length	r Corner Radius	L Overall length	d Shank dia.	Figure No.	Stock
SH300-R4-10005-H	10	25	0.5	75	10	2	○
SH300-R4-10010-H	10	25	1	75	10	2	○
SH300-R4-10020-H	10	25	2	75	10	2	○
SH300-R4-12005-H	12	30	0.5	75	12	2	○
SH300-R4-12010-H	12	30	1	75	12	2	●
SH300-R4-12020-H	12	30	2	75	12	2	○
SH300-R4-16010-H	16	40	1	100	16	2	○
SH300-R4-16020-H	16	40	2	100	16	2	○
SH300-R4-20010-H	20	45	1	100	20	2	○
SH300-R4-20020-H	20	45	2	100	20	2	○
SH300-R4-20030-H	20	45	3	100	20	2	○

- Stock
- Available upon order

D	Tolerance
D ≤ 8	0 -0.01
D > 8	0 -0.015

unit (mm)

Workpiece Material				
P		H		
1 2 3 4	5	1 2	3	4
Carbon Steels Alloy Steels	Alloy Steels	Hardened Steel	Hardened Steel	Hardened Steel
(< 35HRC)	(35-48 HRC)	(< 55HRC)	(55-60HRC)	(> 60HRC)
	○	○	○	○

- Most Suitable
- Suitable

SH300-RH4-H

4 Flute, Corner Radius with Long Shank Length

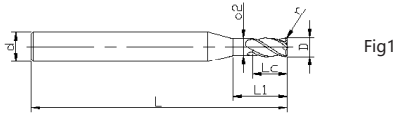

Fig1

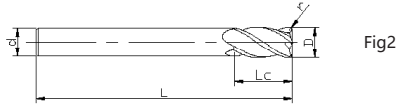
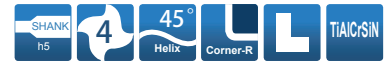

Fig2



Ordering Code	D Mill dia	Lc Flute length	r Corner Radius	L Overall length	d Shank dia.	Figure No.	Stock
SH300-RH4-32001-H	2	7	0.1	60	3	1	○
SH300-RH4-02001J-H	2	6	0.1	60	4	1	○
SH300-RH4-02001-H	2	7	0.1	60	4	1	○
SH300-RH4-62001-H	2	7	0.1	60	6	1	○
SH300-RH4-32002-H	2	7	0.2	60	3	1	○
SH300-RH4-02002-H	2	7	0.2	60	4	1	○
SH300-RH4-62002-H	2	7	0.2	60	6	1	○
SH300-RH4-33002-H	3	10	0.2	60	3	2	○
SH300-RH4-03002-H	3	10	0.2	60	4	1	○
SH300-RH4-63002A-H	3	8	0.2	60	6	1	○
SH300-RH4-63002-H	3	10	0.2	60	6	1	○
SH300-RH4-33005-H	3	10	0.5	60	3	2	○

- Stock
- Available upon order

D	Tolerance
D ≤ 8	0 -0.01
D > 8	0 -0.015

unit (mm)

Workpiece Material				
P		H		
1 2 3 4	5	1 2	3	4
Carbon Steels Alloy Steels	Alloy Steels	Hardened Steel	Hardened Steel	Hardened Steel
(< 35HRC)	(35-48 HRC)	(< 55HRC)	(55-60HRC)	(> 60HRC)
	○	○	⊙	⊙

⊙ Most Suitable ○ Suitable

SH300-RH4-H

4 Flute, Corner Radius with Long Shank Length

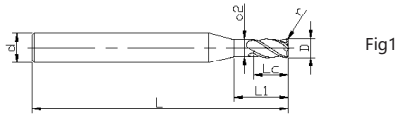

Fig1

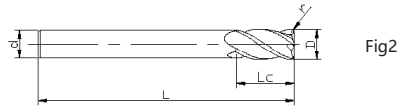

Fig2



Ordering Code	D Mill dia	Lc Flute length	r Corner Radius	L Overall length	d Shank dia.	Figure No.	Stock
SH300-RH4-03005-H	3	10	0.5	60	4	1	○
SH300-RH4-63005-H	3	10	0.5	60	6	1	○
SH300-RH4-04002-H	4	11	0.2	60	4	2	○
SH300-RH4-04005-H	4	11	0.5	60	4	2	○
SH300-RH4-05002-H	5	13	0.2	60	6	1	○
SH300-RH4-05005-H	5	13	0.5	60	6	1	○
SH300-RH4-06005-H	6	16	0.5	60	6	2	○
SH300-RH4-06005E-H	6	16	0.5	75	6	2	○
SH300-RH4-06010-H	6	16	1	60	6	2	○
SH300-RH4-06010E-H	6	16	1	75	6	2	○
SH300-RH4-08005-H	8	20	0.5	100	8	2	○
SH300-RH4-08010-H	8	20	1	100	8	2	○

- Stock
- Available upon order

D	Tolerance
D ≤ 8	0 -0.01
D > 8	0 -0.015

unit (mm)

Workpiece Material				
P		H		
1 2 3 4	5	1 2	3	4
Carbon Steels Alloy Steels	Alloy Steels	Hardened Steel	Hardened Steel	Hardened Steel
(< 35HRC)	(35-48 HRC)	(< 55HRC)	(55-60HRC)	(> 60HRC)
	○	○	○	○

- Most Suitable
- Suitable

SH300-RH4-H

4 Flute, Corner Radius with Long Shank Length

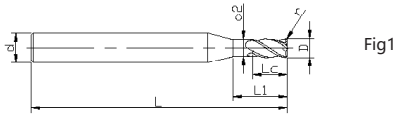

Fig1

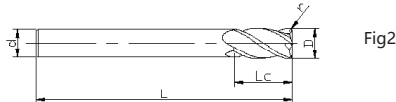
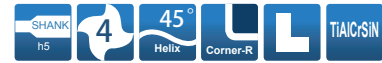

Fig2



Ordering Code	D Mill dia	Lc Flute length	r Corner Radius	L Overall length	d Shank dia.	Figure No.	Stock
SH300-RH4-10005-H	10	25	0.5	100	10	2	○
SH300-RH4-10010-H	10	25	1	100	10	2	○
SH300-RH4-10020-H	10	25	2	100	10	2	●
SH300-RH4-12005-H	12	30	0.5	100	12	2	○
SH300-RH4-12010-H	12	30	1	100	12	2	○
SH300-RH4-12020-H	12	30	2	100	12	2	○
SH300-RH4-16010-H	16	40	1	150	16	2	○
SH300-RH4-16020-H	16	40	2	150	16	2	●
SH300-RH4-20010-H	20	45	1	150	20	2	○
SH300-RH4-20020-H	20	45	2	150	20	2	○
SH300-RH4-20030-H	20	45	2	150	20	2	○
							○

- Stock
- Available upon order

D	Tolerance
D ≤ 8	0 -0.01
D > 8	0 -0.015

unit (mm)

Workpiece Material				
P		H		
1 2 3 4	5	1 2	3	4
Carbon Steels Alloy Steels	Alloy Steels	Hardened Steel	Hardened Steel	Hardened Steel
(< 35HRC)	(35-48 HRC)	(< 55HRC)	(55-60HRC)	(> 60HRC)
	○	○	○	○

- Most Suitable
- Suitable

SH300-RN4-H

4 Flute Corner Radius With Reduced Neck Diameter

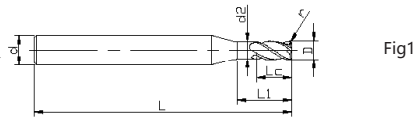

Fig1

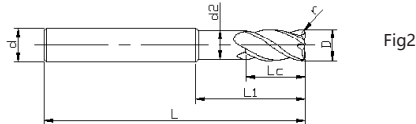

Fig2



Ordering Code	D Mill dia	Lc Flute length	r Corner Radius	L1 Under neck length	d2 Neck dia	L Overall length	d Shank dia	Figure No.	Stock
SH300-RN4-31001-H	1	2	0.1	2	0.95	50	3	1	○
SH300-RN4-01001-H	1	2	0.1	2	0.95	50	4	1	●
SH300-RN4-61001-H	1	2	0.1	2	0.95	50	6	1	○
SH300-RN4-31001E-H	1	2	0.1	2	0.95	60	3	1	○
SH300-RN4-01001E-H	1	2	0.1	2	0.95	60	4	1	○
SH300-RN4-61001E-H	1	2	0.1	2	0.95	60	6	1	○
SH300-RN4-01001M-H	1	2	0.1	2	0.95	60	4	1	○
SH300-RN4-31002-H	1	2	0.2	2	0.95	50	3	1	○
SH300-RN4-01002-H	1	2	0.2	2	0.95	50	4	1	○
SH300-RN4-61002-H	1	2	0.2	2	0.95	50	6	1	○
SH300-RN4-31002E-H	1	2	0.2	2	0.95	60	3	1	○
SH300-RN4-01002E-H	1	2	0.2	2	0.95	60	4	1	○

- Stock
- Available upon order

D	Tolerance
D ≤ 8	0 -0.01
D > 8	0 -0.015

unit (mm)

Workpiece Material				
P		H		
1 2 3 4	5	1 2	3	4
Carbon Steels Alloy Steels	Alloy Steels	Hardened Steel	Hardened Steel	Hardened Steel
(< 35HRC)	(35-48 HRC)	(< 55HRC)	(55-60HRC)	(> 60HRC)
	○	○	○	○

○ Most Suitable ○ Suitable

SH300-RN4-H

4 Flute Corner Radius With Reduced Neck Diameter

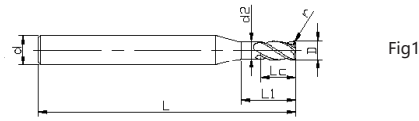

Fig1

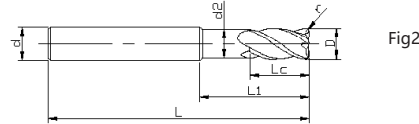
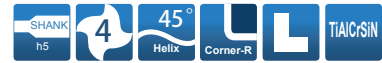

Fig2



Ordering Code	D Mill dia	Lc Flute length	r Corner Radius	L1 Under neck length	d2 Neck dia	L Overall length	d Shank dia	Figure No.	Stock
SH300-RN4-61002E-H	1	2	0.2	2	0.95	60	6	1	○
SH300-RN4-31501-H	1.5	3	0.1	3	1.45	50	3	1	○
SH300-RN4-01501-H	1.5	3	0.1	3	1.45	50	4	1	○
SH300-RN4-61501-H	1.5	3	0.1	3	1.45	50	6	1	○
SH300-RN4-31501E-H	1.5	3	0.1	3	1.45	60	3	1	●
SH300-RN4-01501E-H	1.5	3	0.1	3	1.45	60	4	1	○
SH300-RN4-61501E-H	1.5	3	0.1	3	1.45	60	6	1	○
SH300-RN4-31502-H	1.5	3	0.2	3	1.45	50	3	1	○
SH300-RN4-01502-H	1.5	3	0.2	3	1.45	50	4	1	○
SH300-RN4-61502-H	1.5	3	0.2	3	1.45	50	6	1	○
SH300-RN4-31502E-H	1.5	3	0.2	3	1.45	60	3	1	○
SH300-RN4-01502E-H	1.5	3	0.2	3	1.45	60	4	1	○

- Stock
- Available upon order

D	Tolerance
D ≤ 8	0 -0.01
D > 8	0 -0.015

unit (mm)

Workpiece Material				
P		H		
1 2 3 4	5	1 2	3	4
Carbon Steels Alloy Steels	Alloy Steels	Hardened Steel	Hardened Steel	Hardened Steel
(< 35HRC)	(35-48 HRC)	(< 55HRC)	(55-60HRC)	(> 60HRC)
	○	○	○	○

- Most Suitable
- Suitable

SH300-RN4-H

4 Flute Corner Radius With Reduced Neck Diameter

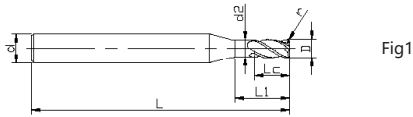

Fig1

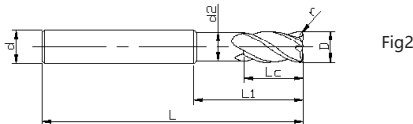

Fig2



Ordering Code	D Mill dia	Lc Flute length	r Corner Radius	L1 Under neck length	d2 Neck dia	L Overall length	d Shank dia	Figure No.	Stock
SH300-RN4-61502E-H	1.5	3	0.2	3	1.45	60	6	1	○
SH300-RN4-32001-H	2	4	0.1	4	1.95	50	3	1	○
SH300-RN4-02001-H	2	4	0.1	4	1.95	50	4	1	○
SH300-RN4-62001-H	2	4	0.1	4	1.95	50	6	1	○
SH300-RN4-32001E-H	2	4	0.1	4	1.95	60	3	1	○
SH300-RN4-02001J-H	2	4	0.1	4	1.95	60	4	1	●
SH300-RN4-02001E-H	2	4	0.1	4	1.95	60	4	1	●
SH300-RN4-62001E-H	2	4	0.1	4	1.95	60	6	1	○
SH300-RN4-32002-H	2	4	0.2	4	1.95	50	3	1	○
SH300-RN4-02002-H	2	4	0.2	4	1.95	50	4	1	○
SH300-RN4-62002-H	2	4	0.2	4	1.95	50	6	1	○
SH300-RN4-32002E-H	2	4	0.2	4	1.95	60	3	1	○

- Stock
- Available upon order

D	Tolerance
D ≤ 8	0 -0.01
D > 8	0 -0.015

unit (mm)

Workpiece Material				
P		H		
1 2 3 4	5	1 2	3	4
Carbon Steels Alloy Steels	Alloy Steels	Hardened Steel	Hardened Steel	Hardened Steel
(< 35HRC)	(35-48 HRC)	(< 55HRC)	(55-60HRC)	(> 60HRC)
	○	○	○	○

○ Most Suitable ○ Suitable

SH300-RN4-H

4 Flute Corner Radius With Reduced Neck Diameter

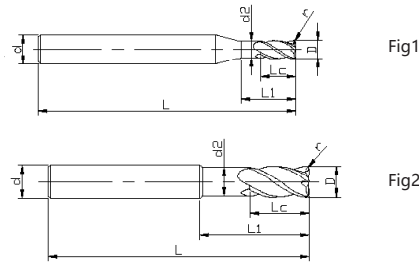

Ordering Code	D Mill dia	Lc Flute length	r Corner Radius	L1 Under neck length	d2 Neck dia	L Overall length	d Shank dia	Figure No.	Stock
SH300-RN4-02002E-H	2	4	0.2	4	1.95	60	4	1	○
SH300-RN4-62002E-H	2	4	0.2	4	1.95	60	6	1	○
SH300-RN4-33002-H	3	6	0.2	6	2.9	50	3	2	○
SH300-RN4-03002-H	3	6	0.2	6	2.9	50	4	1	○
SH300-RN4-63002-H	3	6	0.2	6	2.9	50	6	1	○
SH300-RN4-33002E-H	3	6	0.2	6	2.9	60	3	2	○
SH300-RN4-03002E-H	3	6	0.2	6	2.9	60	4	1	●
SH300-RN4-63002J-H	3	6	0.2	6	2.9	60	6	1	●
SH300-RN4-63002E-H	3	6	0.2	6	2.9	60	6	1	○
SH300-RN4-33005-H	3	6	0.5	6	2.9	50	3	2	○
SH300-RN4-03005-H	3	6	0.5	6	2.9	50	4	1	○
SH300-RN4-63005-H	3	6	0.5	6	2.9	50	6	1	○

- Stock
- Available upon order

D	Tolerance
D ≤ 8	0 -0.01
D > 8	0 -0.015

unit (mm)

Workpiece Material				
P		H		
1 2 3 4	5	1 2	3	4
Carbon Steels Alloy Steels	Alloy Steels	Hardened Steel	Hardened Steel	Hardened Steel
(< 35HRC)	(35-48 HRC)	(< 55HRC)	(55-60HRC)	(> 60HRC)
	○	○	○	○

- Most Suitable
- Suitable

SH300-RN4-H

4 Flute Corner Radius With Reduced Neck Diameter

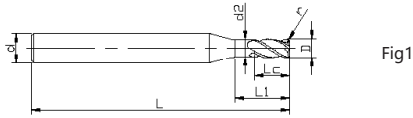

Fig1

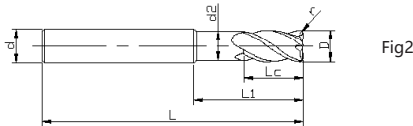

Fig2



Ordering Code	D Mill dia	Lc Flute length	r Corner Radius	L1 Under neck length	d2 Neck dia	L Overall length	d Shank dia	Figure No.	Stock
SH300-RN4-33005E-H	3	6	0.5	6	2.9	60	3	2	○
SH300-RN4-03005E-H	3	6	0.5	6	2.9	60	4	1	○
SH300-RN4-63005E-H	3	6	0.5	6	2.9	60	6	1	○
SH300-RN4-04002-H	4	8	0.2	8	3.9	50	4	2	○
SH300-RN4-64002-H	4	8	0.2	8	3.9	50	4	2	○
SH300-RN4-04002E-H	4	8	0.2	8	3.9	60	4	2	○
SH300-RN4-64002E-H	4	8	0.2	8	3.9	60	4	2	○
SH300-RN4-04005-H	4	8	0.5	8	3.9	50	4	2	●
SH300-RN4-64005-H	4	8	0.5	8	3.9	50	6	1	●
SH300-RN4-04005E-H	4	8	0.5	8	3.9	60	4	2	○
SH300-RN4-64005E-H	4	8	0.5	8	3.9	60	6	1	○
SH300-RN4-64005L-H	4	8	0.5	8	3.9	60	6	1	●

- Stock
- Available upon order

D	Tolerance
D ≤ 8	0 -0.01
D > 8	0 -0.015

unit (mm)

Workpiece Material				
P		H		
1 2 3 4	5	1 2	3	4
Carbon Steels Alloy Steels	Alloy Steels	Hardened Steel	Hardened Steel	Hardened Steel
(< 35HRC)	(35-48 HRC)	(< 55HRC)	(55-60HRC)	(> 60HRC)
	○	○	○	○

- Most Suitable
- Suitable

SH300-RN4-H

4 Flute Corner Radius With Reduced Neck Diameter

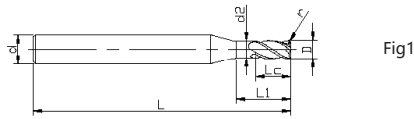

Fig1

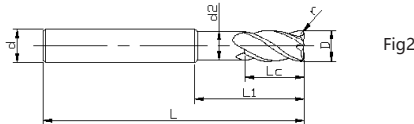

Fig2



Ordering Code	D Mill dia	Lc Flute length	r Corner Radius	L1 Under neck length	d2 Neck dia	L Overall length	d Shank dia	Figure No.	Stock
SH300-RN4-05002-H	5	10	0.2	10	4.9	50	6	1	○
SH300-RN4-05002F-H	5	10	0.2	10	4.9	75	6	1	○
SH300-RN4-05005-H	5	10	0.5	10	4.9	50	6	1	○
SH300-RN4-05005F-H	5	10	0.5	10	4.9	75	6	1	○
SH300-RN4-06005J-H	6	12	0.5	12	5.9	60	6	2	○
SH300-RN4-06005-H	6	12	0.5	12	5.9	50	6	2	○
SH300-RN4-06005E-H	6	12	0.5	12	5.9	60	6	2	○
SH300-RN4-06005F-H	6	12	0.5	12	5.9	75	6	2	●
SH300-RN4-06010-H	6	12	1	12	5.9	50	6	2	○
SH300-RN4-06010E-H	6	12	1	12	5.9	60	6	2	○
SH300-RN4-06010F-H	6	12	1	12	5.9	75	6	2	○
SH300-RN4-08005-H	8	16	0.5	16	7.9	60	8	2	○

- Stock
- Available upon order

D	Tolerance
D ≤ 8	0 -0.01
D > 8	0 -0.015

unit (mm)

Workpiece Material				
P		H		
1	2	3	4	5
1234	5	12	3	4
Carbon Steels Alloy Steels	Alloy Steels	Hardened Steel	Hardened Steel	Hardened Steel
(< 35HRC)	(35-48 HRC)	(< 55HRC)	(55-60HRC)	(> 60HRC)
	○	○	○	○

- Most Suitable
- Suitable

SH300-RN4-H

4 Flute Corner Radius With Reduced Neck Diameter

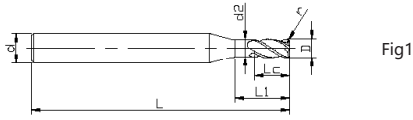

Fig1

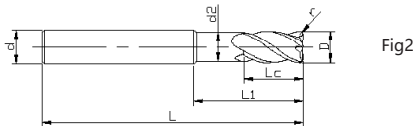

Fig2



Ordering Code	D Mill dia	Lc Flute length	r Corner Radius	L1 Under neck length	d2 Neck dia	L Overall length	d Shank dia	Figure No.	Stock
SH300-RN4-08005E-H	8	16	0.5	16	7.9	75	8	2	○
SH300-RN4-08010-H	8	16	1	16	7.9	60	8	2	○
SH300-RN4-08010E-H	8	16	1	16	7.9	75	8	2	●
SH300-RN4-10005-H	10	20	0.5	20	9.9	75	10	2	○
SH300-RN4-10005F-H	10	20	0.5	20	9.9	100	10	2	○
SH300-RN4-10010-H	10	20	1	20	9.9	75	10	2	○
SH300-RN4-10010F-H	10	20	1	20	9.9	100	10	2	○
SH300-RN4-10020-H	10	20	2	20	9.9	75	10	2	○
SH300-RN4-10020F-H	10	20	2	20	9.9	100	10	2	○
SH300-RN4-12005-H	12	24	0.5	24	11.9	75	12	2	○
SH300-RN4-12005F-H	12	24	0.5	24	11.9	100	12	2	○
SH300-RN4-12010-H	12	24	1	24	11.9	75	12	2	○

- Stock
- Available upon order

D	Tolerance
D ≤ 8	0 -0.01
D > 8	0 -0.015

unit (mm)

Workpiece Material				
P		H		
1 2 3 4	5	1 2	3	4
Carbon Steels Alloy Steels	Alloy Steels	Hardened Steel	Hardened Steel	Hardened Steel
(< 35HRC)	(35-48 HRC)	(< 55HRC)	(55-60HRC)	(> 60HRC)
	○	○	○	○

○ Most Suitable ○ Suitable

SH300-RN4-H

4 Flute Corner Radius With Reduced Neck Diameter

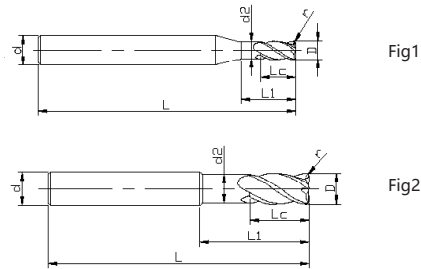

Ordering Code	D Mill dia	Lc Flute length	r Corner Radius	L1 Under neck length	d2 Neck dia	L Overall length	d Shank dia	Figure No.	Stock
SH300-RN4-12010F-H	12	24	1	24	11.9	100	12	2	●
SH300-RN4-12020-H	12	24	2	24	11.9	75	12	2	○
SH300-RN4-12020F-H	12	24	2	24	11.9	100	12	2	○

- Stock
- Available upon order

D	Tolerance
D ≤ 8	0 -0.01
D > 8	0 -0.015

unit (mm)

Workpiece Material				
P		H		
1 2 3 4	5	1 2	3	4
Carbon Steels Alloy Steels	Alloy Steels	Hardened Steel	Hardened Steel	Hardened Steel
(< 35HRC)	(35-48 HRC)	(< 55HRC)	(55-60HRC)	(> 60HRC)
	○	○	○	○

○ Most Suitable ○ Suitable

SH300-S6-H

6 Flute, Standard Length

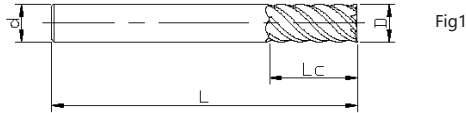

Ordering Code	D Mill dia	Lc Flute length	L Overall length	d Shank dia	Figure No.	Stock
SH300-S6-06015-H	6	50	50	6	1	●
SH300-S6-08020-H	8	60	60	8	1	●
SH300-S6-08020E-H	8	75	75	8	1	○
SH300-S6-10025-H	10	75	75	10	1	●
SH300-S6-12030-H	12	75	75	12	1	○
SH300-S6-14035-H	14	100	100	14	1	○
SH300-S6-16040-H	16	100	100	16	1	○
SH300-S6-18040-H	18	100	100	18	1	○
SH300-S6-20045-H	20	100	100	20	1	○

- Stock
- Available upon order

D	Tolerance
D ≤ 8	0 -0.01
D > 8	0 -0.015

unit (mm)

Workpiece Material				
P		H		
1 2 3 4	5	1 2	3	4
Carbon Steels Alloy Steels	Alloy Steels	Hardened Steel	Hardened Steel	Hardened Steel
(< 35HRC)	(35-48 HRC)	(< 55HRC)	(55-60HRC)	(> 60HRC)
	○	○	⊙	⊙

- ⊙ Most Suitable
- Suitable

SH300-SH6-H

6 Flute, Long Shank Length

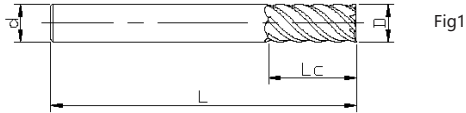

Ordering Code	D Mill dia	Lc Flute length	L Overall length	d Shank dia	Figure No.	Stock
SH300-SH6-06015-H	6	60	60	6	1	○
SH300-SH6-06015E-H	6	75	75	6	1	○
SH300-SH6-08020-H	8	90	90	8	1	○
SH300-SH6-10025-H	10	100	100	10	1	○
SH300-SH6-12030-H	12	100	100	12	1	●
SH300-SH6-14035-H	14	120	120	14	1	○
SH300-SH6-16040-H	16	120	120	16	1	○
SH300-SH6-18040-H	18	120	120	18	1	○
SH300-SH6-20045-H	20	120	120	20	1	○

- Stock
- Available upon order

D	Tolerance
D ≤ 8	0 -0.01
D > 8	0 -0.015

unit (mm)

Workpiece Material				
P		H		
1 2 3 4	5	1 2	3	4
Carbon Steels Alloy Steels	Alloy Steels	Hardened Steel	Hardened Steel	Hardened Steel
(< 35HRC)	(35-48 HRC)	(< 55HRC)	(55-60HRC)	(> 60HRC)
	○	○	○	○

- Most Suitable
- Suitable

SH300-SL6-H

6 Flute, Long Flute Length

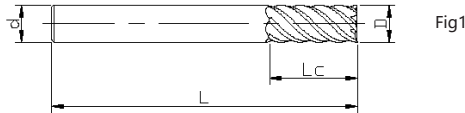

Ordering Code	D Mill dia	Lc Flute length	L Overall length	d Shank dia	Figure No.	Stock
SH300-SL6-06025-H	6	75	75	6	1	○
SH300-SL6-08035-H	8	100	100	8	1	○
SH300-SL6-10045-H	10	100	100	10	1	○
SH300-SL6-12055-H	12	100	100	12	1	○
SH300-SL6-14055-H	14	120	120	14	1	○
SH300-SL6-16065-H	16	120	120	16	1	○
SH300-SL6-16065-H	16	120	120	16	1	○
SH300-SL6-20065-H	20	150	150	20	1	○

- Stock
- Available upon order

D	Tolerance
D ≤ 8	0 -0.01
D > 8	0 -0.015

unit (mm)

Workpiece Material				
P		H		
1 2 3 4	5	1 2	3	4
Carbon Steels Alloy Steels	Alloy Steels	Hardened Steel	Hardened Steel	Hardened Steel
(< 35HRC)	(35-48 HRC)	(< 55HRC)	(55-60HRC)	(> 60HRC)
	○	○	○	○

○ Most Suitable ○ Suitable

SH300-R6-H

6 Flute, Corner Radius

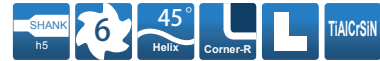
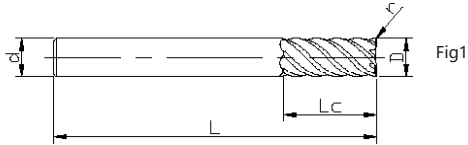

Ordering Code	D Mill dia	Lc Flute length	r Corner Radius	L Overall length	d Shank dia	Figure No.	Stock
SH300-R6-06005-H	6	15	0.5	50	6	1	●
SH300-R6-06010-H	6	15	1	50	6	1	○
SH300-R6-08005-H	8	20	0.5	60	8	1	○
SH300-R6-08010-H	8	20	1	60	8	1	○
SH300-R6-08005E-H	8	20	0.5	75	8	1	●
SH300-R6-08010E-H	8	20	1	75	8	1	○
SH300-R6-10005-H	10	25	0.5	75	10	1	○
SH300-R6-10010-H	10	25	1	75	10	1	●
SH300-R6-10020-H	10	25	2	75	10	1	○
SH300-R6-12005-H	12	30	0.5	75	12	1	○
SH300-R6-12010-H	12	30	1	75	12	1	○
SH300-R6-12020-H	12	30	2	75	12	1	○

- Stock
- Available upon order

D	Tolerance
D ≤ 8	0 -0.01
D > 8	0 -0.015

unit (mm)

Workpiece Material				
P		H		
1 2 3 4	5	1 2	3	4
Carbon Steels Alloy Steels	Alloy Steels	Hardened Steel	Hardened Steel	Hardened Steel
(< 35HRC)	(35-48 HRC)	(< 55HRC)	(55-60HRC)	(> 60HRC)
	○	○	○	○

○ Most Suitable ○ Suitable

SH300-R6-H

6 Flute, Corner Radius

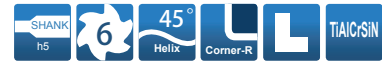
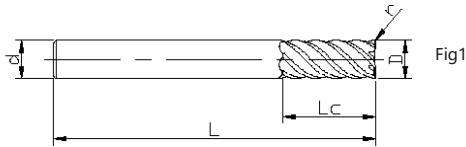

Ordering Code	D Mill dia	Lc Flute length	r Corner Radius	L Overall length	d Shank dia	Figure No.	Stock
SH300-R6-14005-H	14	35	0.5	100	14	1	○
SH300-R6-14010-H	14	35	1	100	14	1	○
SH300-R6-14020-H	14	35	2	100	14	1	○
SH300-R6-16010-H	16	40	1	100	16	1	○
SH300-R6-16020-H	16	40	2	100	16	1	○
SH300-R6-16030-H	16	40	3	100	16	1	○
SH300-R6-20010-H	20	45	1	100	20	1	○
SH300-R6-20020-H	20	45	2	100	20	1	○
SH300-R6-20030-H	20	45	3	100	20	1	○

- Stock
- Available upon order

D	Tolerance
D ≤ 8	0 -0.01
D > 8	0 -0.015

unit (mm)

Workpiece Material				
P		H		
1 2 3 4	5	1 2	3	4
Carbon Steels Alloy Steels	Alloy Steels	Hardened Steel	Hardened Steel	Hardened Steel
(< 35HRC)	(35-48 HRC)	(< 55HRC)	(55-60HRC)	(> 60HRC)
	○	○	○	○

○ Most Suitable ○ Suitable

SH300-RH6-H

6 Flute, Corner Radius With Long Shank Length

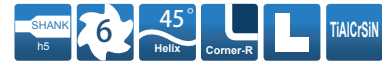
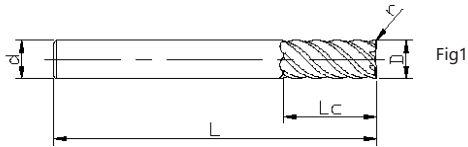

Ordering Code	D Mill dia	Lc Flute length	r Corner Radius	L Overall length	d Shank dia	Figure No.	Stock
SH300-RH6-06005-H	6	15	0.5	60	6	1	○
SH300-RH6-06010-H	6	15	1	60	6	1	○
SH300-RH6-06005E-H	6	15	0.5	75	6	1	○
SH300-RH6-06010E-H	6	15	1	75	6	1	○
SH300-RH6-08005-H	8	20	0.5	75	8	1	○
SH300-RH6-08010-H	8	20	1	75	8	1	○
SH300-RH6-10005-H	10	25	0.5	100	10	1	○
SH300-RH6-10010-H	10	25	1	100	10	1	○
SH300-RH6-10020-H	10	25	2	100	10	1	○
SH300-RH6-12005-H	12	30	0.5	100	12	1	○
SH300-RH6-12010-H	12	30	1	100	12	1	●
SH300-RH6-12020-H	12	30	2	100	12	1	○

- Stock
- Available upon order

D	Tolerance
D ≤ 8	0 -0.01
D > 8	0 -0.015

unit (mm)

Workpiece Material				
P		H		
1 2 3 4	5	1 2	3	4
Carbon Steels Alloy Steels	Alloy Steels	Hardened Steel	Hardened Steel	Hardened Steel
(< 35HRC)	(35-48 HRC)	(< 55HRC)	(55-60HRC)	(> 60HRC)
	○	○	○	○

- Most Suitable
- Suitable

SH300-RH6-H

6 Flute, Corner Radius With Long Shank Length

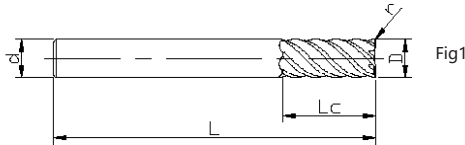

Ordering Code	D Mill dia	Lc Flute length	r Corner Radius	L Overall length	d Shank dia	Figure No.	Stock
SH300-RH6-14005-H	14	35	0.5	120	14	1	○
SH300-RH6-14010-H	14	35	1	120	14	1	○
SH300-RH6-14020-H	14	35	2	120	14	1	○
SH300-RH6-16010-H	16	40	1	120	16	1	○
SH300-RH6-16020-H	16	40	2	120	16	1	○
SH300-RH6-16030-H	16	40	3	120	16	1	○
SH300-RH6-20002-H	20	45	0.2	120	20	1	○
SH300-RH6-20010-H	20	45	1	120	20	1	○
SH300-RH6-20020-H	20	45	2	120	20	1	○
SH300-RH6-20030-H	20	45	3	120	20	1	○

- Stock
- Available upon order

D	Tolerance
D ≤ 8	0 -0.01
D > 8	0 -0.015

unit (mm)

Workpiece Material				
P		H		
1 2 3 4	5	1 2	3	4
Carbon Steels Alloy Steels	Alloy Steels	Hardened Steel	Hardened Steel	Hardened Steel
(< 35HRC)	(35-48 HRC)	(< 55HRC)	(55-60HRC)	(> 60HRC)
	○	○	○	○

- Most Suitable
- Suitable

SH300-RL6-H

6 Flute, Corner Radius With Long Edge Length

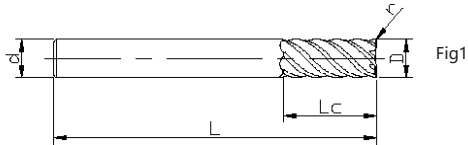

Ordering Code	D Mill dia	Lc Flute length	r Corner Radius	L Overall length	d Shank dia	Figure No.	Stock
SH300-RL6-06002E-H	6	25	0.2	100	6	1	○
SH300-RL6-06002F-H	6	45	0.2	120	6	1	○
SH300-RL6-08002E-H	8	35	0.2	100	8	1	○
SH300-RL6-08002F-H	8	45	0.2	100	8	1	○
SH300-RL6-10002E-H	10	45	0.2	120	10	1	○
SH300-RL6-12002E-H	12	45	0.2	150	12	1	○

- Stock
- Available upon order

D	Tolerance
D ≤ 8	0 -0.01
D > 8	0 -0.015

unit (mm)

Workpiece Material				
P		H		
1 2 3 4	5	1 2	3	4
Carbon Steels Alloy Steels	Alloy Steels	Hardened Steel	Hardened Steel	Hardened Steel
(< 35HRC)	(35-48 HRC)	(< 55HRC)	(55-60HRC)	(> 60HRC)
	○	○	○	○

- Most Suitable
- Suitable

SH300-B2-H

2 Flute, Ballnose Standard Length

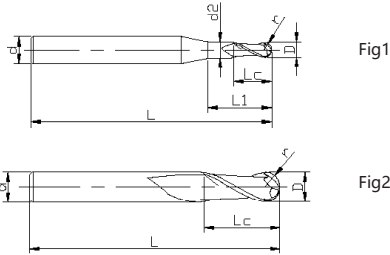

Ordering Code	D Mill dia	Lc Flute length	r Corner Radius	L Overall length	d Shank dia	Figure No.	Stock
SH300-B2-30601-H	0.6	0.9	0.3	50	3	1	○
SH300-B2-00601-H	0.6	0.9	0.3	50	4	1	○
SH300-B2-60601-H	0.6	0.9	0.3	50	6	1	○
SH300-B2-31002-H	1	1.5	0.5	50	3	1	○
SH300-B2-01002-H	1	1.5	0.5	50	4	1	○
SH300-B2-61002-H	1	1.5	0.5	50	6	1	○
SH300-B2-31502-H	1.5	2.3	0.75	50	3	1	○
SH300-B2-01502-H	1.5	2.3	0.75	50	4	1	○
SH300-B2-61502-H	1.5	2.3	0.75	50	6	1	○
SH300-B2-32003-H	2	3	1	50	3	1	○
SH300-B2-02003-H	2	3	1	50	4	1	●
SH300-B2-62003-H	2	3	1	50	6	1	○

- Stock
- Available upon order

D	Tolerance
D ≤ 12	±0.005
D > 12	±0.007

unit (mm)

Workpiece Material				
P		H		
1 2 3 4	5	1 2	3	4
Carbon Steels Alloy Steels	Alloy Steels	Hardened Steel	Hardened Steel	Hardened Steel
(< 35HRC)	(35-48 HRC)	(< 55HRC)	(55-60HRC)	(> 60HRC)
	○	○	○	○

- Most Suitable
- Suitable

SH300-B2-H

2 Flute, Ballnose Standard Length

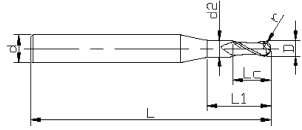

Fig1

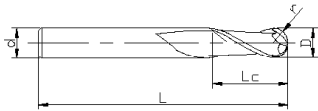

Fig2



Ordering Code	D Mill dia	Lc Flute length	r Corner Radius	L Overall length	d Shank dia	Figure No.	Stock
SH200-B2-33005-H	3	4.5	1.5	50	3	2	○
SH200-B2-03005-H	3	4.5	1.5	50	4	1	○
SH200-B2-63005-H	3	4.5	1.5	50	6	1	○
SH300-B2-04006-H	4	6	2	50	4	2	○
SH300-B2-64006-H	4	6	2	50	6	1	○
SH300-B2-05008-H	5	7.5	2.5	50	6	1	○
SH300-B2-06009-H	6	9	3	50	6	2	○
SH300-B2-08012-H	8	12	4	60	8	2	○
SH300-B2-08012E-H	8	12	4	75	8	2	○
SH300-B2-10015-H	10	15	5	75	10	2	●
SH300-B2-12018-H	12	18	6	75	12	2	●
SH300-B2-62003-H	2	3	1	50	6	1	○

- Stock
- Available upon order

D	Tolerance
D ≤ 12	±0.005
D > 12	±0.007

unit (mm)

Workpiece Material				
P		H		
1	2	3	4	5
Carbon Steels	Alloy Steels	Hardened Steel	Hardened Steel	Hardened Steel
(< 35HRC)	(35-48 HRC)	(< 55HRC)	(55-60HRC)	(> 60HRC)
	○	○	○	○

- Most Suitable
- Suitable

SH300-BH2-H

2 Flute, Ballnose With Long Shank Length

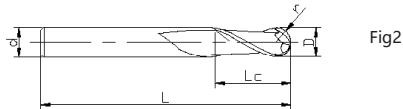
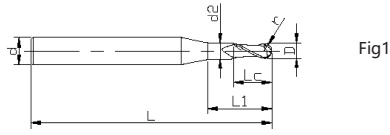

Ordering Code	D Mill dia	Lc Flute length	r Corner Radius	L Overall length	d Shank dia	Figure No.	Stock
SH300-BH2-30601-H	0.6	0.9	0.3	60	3	1	○
SH300-BH2-00601-H	0.6	0.9	0.3	60	4	1	○
SH300-BH2-60601-H	0.6	0.9	0.3	60	6	1	○
SH300-BH2-31002-H	1	1.5	0.5	60	3	1	○
SH300-BH2-01002-H	1	1.5	0.5	60	4	1	○
SH300-BH2-61002-H	1	1.5	0.5	60	6	1	○
SH300-BH2-31502-H	1.5	2.3	0.75	60	3	1	○
SH300-BH2-01502-H	1.5	2.3	0.75	60	4	1	○
SH300-BH2-61502-H	1.5	2.3	0.75	60	6	1	○
SH300-BH2-32003-H	2	3	1	60	3	1	○
SH300-BH2-02003-H	2	3	1	60	4	1	○
SH300-BH2-62003-H	2	3	1	60	6	1	○

- Stock
- Available upon order

D	Tolerance
D ≤ 12	±0.005
D > 12	±0.007

unit (mm)

Workpiece Material				
P		H		
1 2 3 4	5	1 2	3	4
Carbon Steels Alloy Steels	Alloy Steels	Hardened Steel	Hardened Steel	Hardened Steel
(< 35HRC)	(35-48 HRC)	(< 55HRC)	(55-60HRC)	(> 60HRC)
	○	○	○	○

- Most Suitable
- Suitable

SH300-BH2-H

2 Flute, Ballnose With Long Shank Length

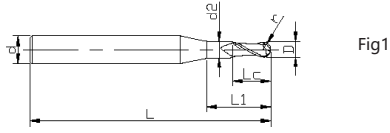

Fig1

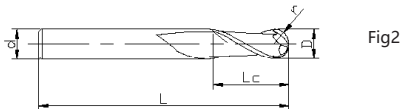

Fig2



Ordering Code	D Mill dia	Lc Flute length	r Corner Radius	L Overall length	d Shank dia	Figure No.	Stock
SH300-BH2-04006-H	4	6	2	60	4	2	○
SH300-BH2-64006-H	4	6	2	60	6	1	○
SH300-BH2-05008-H	5	7.5	2.5	60	6	1	○
SH300-BH2-06009-H	6	9	3	60	6	2	○
SH300-BH2-06009E-H	6	9	3	75	6	2	○
SH300-BH2-08012-H	8	12	4	100	8	2	○
SH300-BH2-10015-H	10	15	5	100	10	2	○
SH300-BH2-12018-H	12	18	6	100	12	2	○

- Stock
- Available upon order

D	Tolerance
D ≤ 12	±0.005
D > 12	±0.007

unit (mm)

Workpiece Material				
P		H		
1 2 3 4	5	1 2	3	4
Carbon Steels Alloy Steels	Alloy Steels	Hardened Steel	Hardened Steel	Hardened Steel
(< 35HRC)	(35-48 HRC)	(< 55HRC)	(55-60HRC)	(> 60HRC)
	○	○	●	●

● Most Suitable ○ Suitable

SH300-BN2-H

2 Flute, Ballnose With Reduced Neck Diameter

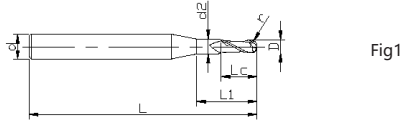

Fig1

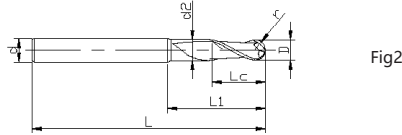

Fig2



Ordering Code	D Mill dia	Lc Flute length	r Corner Radius	d2 Neck dia	L1 Under neck length	L Overall length	d Shank dia	Figure No.	Stock
SH300-BN2-30602-H	0.6	0.9	0.3	0.55	1.5	50	3	1	○
SH300-BN2-00602-H	0.6	0.9	0.3	0.55	1.5	50	4	1	○
SH300-BN2-60602-H	0.6	0.9	0.3	0.55	1.5	50	6	1	○
SH300-BN2-31003-H	1	1.5	0.5	0.95	2.5	50	3	1	○
SH300-BN2-01003-H	1	1.5	0.5	0.95	2.5	50	4	1	○
SH300-BN2-61003-H	1	1.5	0.5	0.95	2.5	50	6	1	○
SH300-BN2-01006-H	1	1.5	0.5	0.95	6	50	4	1	○
SH300-BN2-31504-H	1.5	2.3	0.75	1.45	3.75	50	3	1	○
SH300-BN2-01504-H	1.5	2.3	0.75	1.45	3.75	50	4	1	○
SH300-BN2-61504-H	1.5	2.3	0.75	1.45	3.75	50	6	1	○
SH300-BN2-61506-H	1.5	2.3	0.75	1.45	6	50	6	1	○
SH300-BN2-32005-H	2	3	1	1.95	5	50	3	1	○

- Stock
- Available upon order

D	Tolerance
D ≤ 12	±0.005
D > 12	±0.007

unit (mm)

Workpiece Material				
P		H		
1 2 3 4	5	1 2	3	4
Carbon Steels Alloy Steels	Alloy Steels	Hardened Steel	Hardened Steel	Hardened Steel
(< 35HRC)	(35-48 HRC)	(< 55HRC)	(55-60HRC)	(> 60HRC)
	○	○	○	○

- Most Suitable
- Suitable

SH300-BN2-H

2 Flute, Ballnose With Reduced Neck Diameter

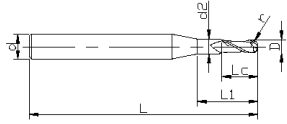

Fig1

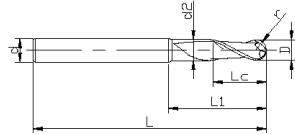

Fig2



Ordering Code	D Mill dia	Lc Flute length	r Corner Radius	d2 Neck dia	L1 Under neck length	L Overall length	d Shank dia	Figure No.	Stock
SH300-BN2-02005-H	2	3	1	1.95	5	50	4	1	●
SH300-BN2-62005-H	2	3	1	1.95	5	50	6	1	○
SH300-BN2-32005E-H	2	3	1	1.95	5	60	3	1	○
SH300-BN2-02005E-H	2	3	1	1.95	5	60	4	1	○
SH300-BN2-62005E-H	2	3	1	1.95	5	60	6	1	○
SH300-BN2-02006E-H	2	3	1	1.95	6	60	6	1	○
SH300-BN2-02008-H	2	3	1	1.95	8	50	4	1	○
SH300-BN2-02010E-H	2	3	1	1.95	10	60	4	1	○
SH200-BN2-33008-H	3	4.5	1.5	2.9	7.5	50	3	2	○
SH200-BN2-03006-H	3	4.5	1.5	2.9	6	50	4	1	○
SH200-BN2-03008-H	3	4.5	1.5	2.9	7.5	50	4	1	○
SH300-BN2-03015E-H	3	4.5	1.5	2.9	15	60	4	1	○

- Stock
- Available upon order

D	Tolerance
D ≤ 12	±0.005
D > 12	±0.007

unit (mm)

Workpiece Material				
P		H		
1 2 3 4	5	1 2	3	4
Carbon Steels Alloy Steels	Alloy Steels	Hardened Steel	Hardened Steel	Hardened Steel
(< 35HRC)	(35-48 HRC)	(< 55HRC)	(55-60HRC)	(> 60HRC)
	○	○	○	○

○ Most Suitable ○ Suitable

SH300-BN2-H

2 Flute, Ballnose With Reduced Neck Diameter

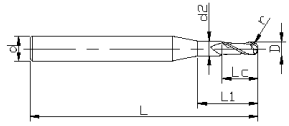

Fig1

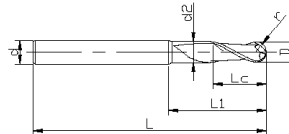

Fig2



Ordering Code	D Mill dia	Lc Flute length	r Corner Radius	d2 Neck dia	L1 Under neck length	L Overall length	d Shank dia	Figure No.	Stock
SH200-BN2-63008-H	3	4.5	1.5	2.9	7.5	50	6	1	○
SH200-BN2-63012-H	3	4.5	1.5	2.9	12	50	6	1	○
SH200-BN2-33008E-H	3	4.5	1.5	2.9	7.5	60	3	2	○
SH200-BN2-03008E-H	3	4.5	1.5	2.9	7.5	60	4	1	○
SH200-BN2-63008E-H	3	4.5	1.5	2.9	7.5	60	6	1	○
SH300-BN2-63009E-H	3	4.5	1.5	2.9	9	60	6	1	○
SH300-BN2-63012E-H	3	4.5	1.5	2.9	12	60	6	1	○
SH300-BN2-63015E-H	3	4.5	1.5	2.9	15	60	6	1	○
SH300-BN2-04010-H	4	6	2	3.9	10	50	4	2	○
SH300-BN2-04010E-H	4	6	2	3.9	10	60	4	2	○
SH300-BN2-64010-H	4	6	2	3.9	10	50	6	1	●
SH300-BN2-64010E-H	4	6	2	3.9	10	60	6	1	○

- Stock
- Available upon order

D	Tolerance
D ≤ 12	±0.005
D > 12	±0.007

unit (mm)

Workpiece Material				
P		H		
1 2 3 4	5	1 2	3	4
Carbon Steels Alloy Steels	Alloy Steels	Hardened Steel	Hardened Steel	Hardened Steel
(< 35HRC)	(35-48 HRC)	(< 55HRC)	(55-60HRC)	(> 60HRC)
	○	○	○	○

- Most Suitable
- Suitable

SH300-BN2-H

2 Flute, Ballnose With Reduced Neck Diameter

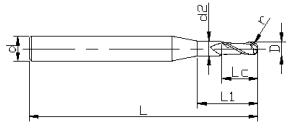

Fig1

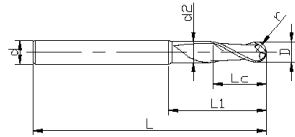
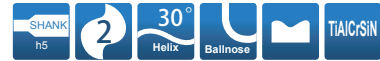

Fig2



Ordering Code	D Mill dia	Lc Flute length	r Corner Radius	d2 Neck dia	L1 Under neck length	L Overall length	d Shank dia	Figure No.	Stock
SH300-BN2-64012E-H	4	6	2	3.9	12	60	6	1	●
SH300-BN2-64016E-H	4	6	2	3.9	16	60	6	1	○
SH300-BN2-04020F-H	4	6	2	3.9	20	75	4	2	○
SH300-BN2-05013-H	5	7.5	2.5	4.9	12.5	50	6	1	○
SH300-BN2-06015-H	6	9	3	5.9	15	50	6	2	●
SH300-BN2-06015E-H	6	9	3	5.9	15	60	6	2	○
SH300-BN2-06015F-H	6	9	3	5.9	15	75	6	2	○
SH300-BN2-06030G-H	6	9	3	5.9	30	100	6	2	●
SH300-BN2-08020-H	8	12	4	7.9	20	60	8	2	●
SH300-BN2-08020E-H	8	12	4	7.9	20	75	8	2	○
SH300-BN2-08020G-H	8	12	4	7.9	20	100	8	2	○
SH300-BN2-08040G-H	8	12	4	7.9	40	100	8	2	○

- Stock
- Available upon order

D	Tolerance
D ≤ 12	±0.005
D > 12	±0.007

unit (mm)

Workpiece Material				
P		H		
1 2 3 4	5	1 2	3	4
Carbon Steels Alloy Steels	Alloy Steels	Hardened Steel	Hardened Steel	Hardened Steel
(< 35HRC)	(35-48 HRC)	(< 55HRC)	(55-60HRC)	(> 60HRC)
	○	○	○	○

- Most Suitable
- Suitable

SH300-BN2-H

2 Flute, Ballnose With Reduced Neck Diameter

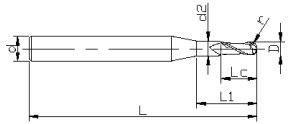

Fig1

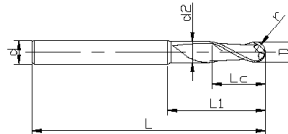

Fig2



Ordering Code	D Mill dia	Lc Flute length	r Corner Radius	d2 Neck dia	L1 Under neck length	L Overall length	d Shank dia	Figure No.	Stock
SH300-BN2-10025-H	10	15	5	9.9	25	75	10	2	○
SH300-BN2-10025F-H	10	15	5	9.9	25	100	10	2	○
SH300-BN2-12030-H	12	18	6	11.9	30	75	12	2	○
SH300-BN2-12030F-H	12	18	6	11.9	30	100	12	2	○

- Stock
- Available upon order

D	Tolerance
D ≤ 12	±0.005
D > 12	±0.007

unit (mm)

Workpiece Material				
P		H		
1 2 3 4	5	1 2	3	4
Carbon Steels Alloy Steels	Alloy Steels	Hardened Steel	Hardened Steel	Hardened Steel
(< 35HRC)	(35-48 HRC)	(< 55HRC)	(55-60HRC)	(> 60HRC)
	○	○	○	○

○ Most Suitable ○ Suitable

SH300-SS4、S4、SH4、SL4、SN4-H SH300-R4、RH4、RN4-H

For Alloy Steels, Harden Steels—— Side Milling



Workpiece Material		(mm)	Vc m/ min	(mm)	1	2	4	6	8	10	12	14	16	20
H	(< 55HRC)	$ap \leq 1D$	150	(min-1)	40000	24000	12000	8000	6000	4800	4000	3400	3000	2400
		$ae \leq 0.02D$		(mm/ min)	1350	1440	2400	1760	1440	1248	1200	1088	1080	960
	(55-60HRC)	$ap \leq 1D$	130	(min-1)	30000	18000	10350	6900	5175	4140	3450	3000	2500	2000
		$ae \leq 0.015D$		(mm/ min)	1000	1080	2070	1518	1242	1076.4	1035	960	900	800
	(> 60HRC)	$ap \leq 1D$	100	(min-1)	20000	14000	7960	5300	4000	3280	2600	2300	2000	1600
		$ae \leq 0.01D$		(mm/ min)	800	840	1592	1166	960	852.8	780	736	720	640

SH300-B2、BH2、BN2-H

For Alloy Steels, Hardenend Steels—— Profiling Milling



Workpiece Material		(mm)	Vc m/ min	(mm)	0.6	1	2	4	6	8	10	12
H	(< 55HRC)	$ap \leq 1D$	140	(min-1)	44000	23000	16000	10000	7400	5700	4500	3800
		$ae \leq 0.02D$		(mm/ min)	1100	1200	1770	1680	1500	1300	1100	1000
	(55-60HRC)	$ap \leq 1D$	120	(min-1)	41000	21000	14000	9500	5100	4100	3500	2600
		$ae \leq 0.015D$		(mm/ min)	1000	1200	1480	1390	1300	1170	1000	800
	(> 60HRC)	$ap \leq 1D$	100	(min-1)	40000	20000	13000	7000	5100	3900	3100	2600
		$ae \leq 0.01D$		(mm/ min)	700	800	1300	1100	960	800	700	600

Note :

1. Make sure work piece and machine are stable and use a precision holder.
2. Please adjust the speed, feed and cutting depth according to actual cutting conditons.
3. The milling conditions are for an end mill where the tool overhang length is less than 4*D(Mill dia).When the tool overhang length is longer, please adjust the speed, feed and cutting depth.

SH300-S6、SH6、SL6、R6、RH6-H

For Alloy Steels, Hardened Steels—— Side Milling



Workpiece Material		(mm)	Vc m/ min	(mm)	6	8	10	12	14	16	20
H	(< 55HRC)	$ap \leq 1D$	120	(min-1)	6200	4800	4000	3200	2800	2400	1600
		$ae \leq 0.02D$		(mm/ min)	1674	1584	1560	1440	1344	1296	960
	(55- 60HRC)	$ap \leq 1D$	100	(min-1)	4500	3600	3000	2400	2100	1800	1200
		$ae \leq 0.015D$		(mm/ min)	1215	1188	1170	1080	1020	972	720
	(> 60HRC)	$ap \leq 1D$	70	(min-1)	3100	2400	2000	1600	1400	1200	800
		$ae \leq 0.01D$		(mm/ min)	744	720	720	627	600	576	432

Note :

1. Make sure work piece and machine are stable and use a precision holder.
2. Please adjust the speed, feed and cutting depth according to actual cutting conditons.
3. The milling conditions are for an end mill where the tool overhang length is less than 4*D(Mill dia).When the tool overhang length is longer, please adjust the speed, feed and cutting depth.